

ELMHURST QUEENS BOULEVARD

LOCATION:

89-23/25 Queens Boulevard
Elmhurst, Queens, NY 11373

SIZE: GLA 4,477 Rentable SF

89-23 Queens Blvd: Razkuzen 2,340 SF

89-25A Queens Blvd: Available 972 SF

89-25B Queens Blvd: Wine & Liquor
1,165 SF

No Basement or Sprinkler System.

CALL FOR AVAILABILITIES

ZONING: C1-2 Overlay in R6.

**PARKING: Metered Street Parking and
Garages near by.**

**OTHER PROJECT TENANTS: Chase
Bank and Razkuzen Buffet Restaurant.**



NEARBY TENANTS: On same block with White Castle and Bank of America. Between Queens Center Mall featuring JC Penny's, Macy's and many others and Queens Place featuring Target, Best Buy, DSW and others.

NEIGHBORHOOD: Densely populated middle income neighborhood, near Subway lines and numerous bus Lines. Tremendous Pedestrian and Vehicular Traffic.

PRICE: TBD RE Tax - \$26/sq ft, CAM & Insurance - \$5/sq ft.

NOTE: Excellent Queens Blvd location between two major Malls. Excellent Pedestrian Traffic!

2019	1/2 Mile	1 Mile	3 Mile
Estimated Population	42,872	190,433	916,588
Estimated Average HH Income	\$74,021	\$73,984	\$82,298



This property is offered subject to availability, errors, omissions, or changes in price or terms without notice.

A MNP COMPANY

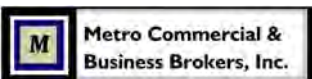

For more information and inspection, contact
Metro Commercial & Business Brokers, Inc.
425 Linda Drive, East Meadow, NY 11554
www.metrocbb.com



John R. Wilmarth
(516) 640-5440 john@metrocb.com

Gerry Dantone
(631) 623-6914 metrocb@aol.com

89-23/25 Queens Blvd, Elmhurst, NY 11373



For more information and inspection, contact
Metro Commercial & Business Brokers, Inc.
425 Linda Drive, East Meadow, NY 11554

www.metrocbb.com

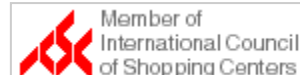

John R. Wilmarth
(516) 640-5440 john@metrocb.com

Gerry Dantone
(631) 623-6914 metrocb@aol.com

89-23/25 Queens Blvd, Elmhurst, Queens, NY 11373



M Metro Commercial & Business Brokers, Inc.

For more information and inspection, contact
Metro Commercial & Business Brokers, Inc.
425 Linda Drive, East Meadow, NY 11554

Member of
International Council
of Shopping Centers

www.metrocbb.com

John R. Wilmarth
(516) 640-5440 john@metrocb.com

Gerry Dantone
(631) 623-6914 metrocb@aol.com

89-23 25 Queens Blvd, Elmhurst, Queens, NY 11373

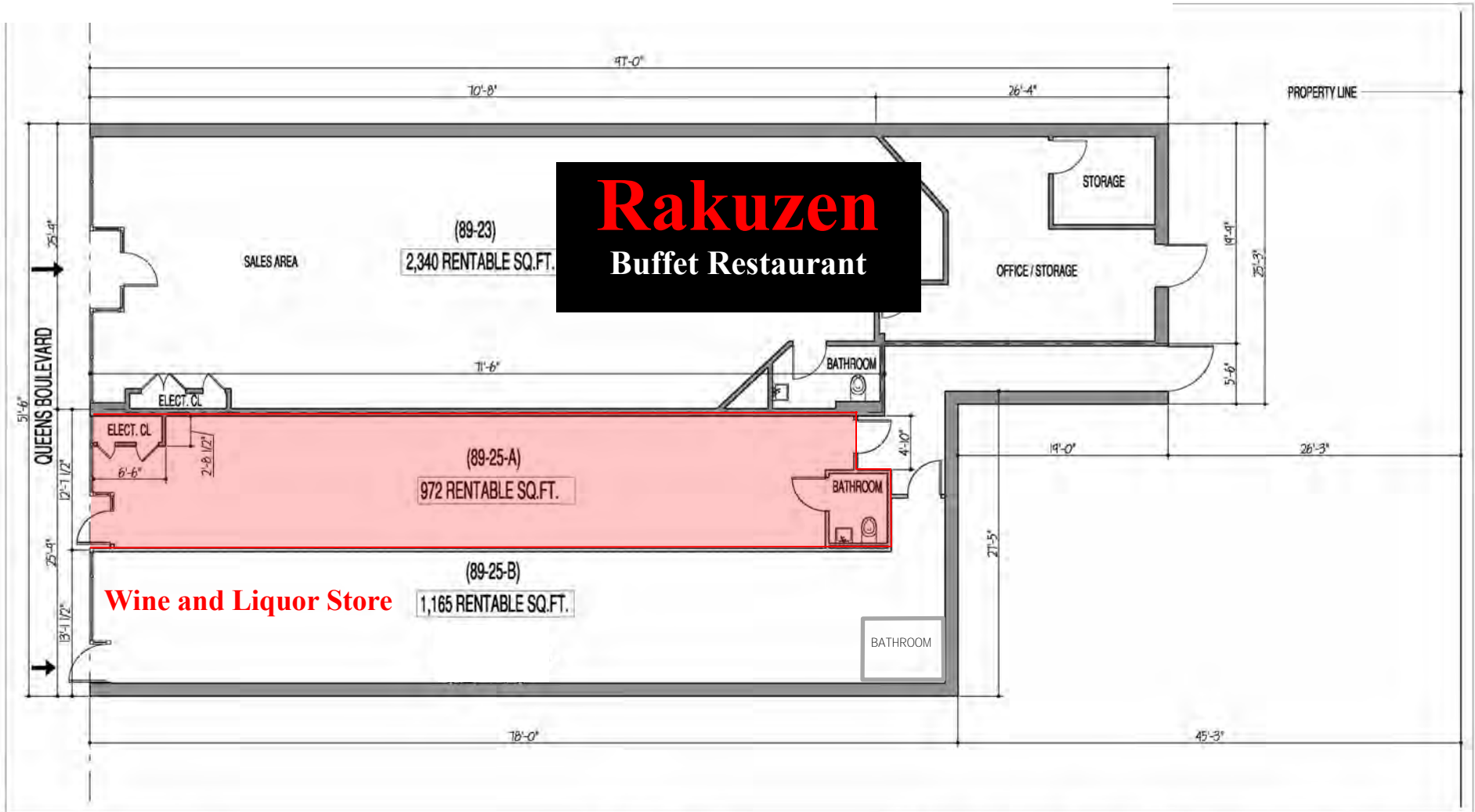

8923 & 8925 Queens Blvd.
 Elmhurst, NY

DRAWING TITLE
 AS-BUILT PLANS
 'QUEENS BOULEVARD'

JOB NUMBER 33069.00
 DRAWN BY CL
 SCALE 1/8"=1'-0"
 DRAWING NO. **A.1**

**TULLER
 McNEALUS
 FELD**
 ARCHITECTURE
 INTERIOR DESIGN
 54 West 59th Street
 New York, NY 10019
 Tel: (212) 758-7788
 Fax: (212) 768-9171



For more information and inspection, contact
Metro Commercial & Business Brokers, Inc.
 425 Linda Drive, East Meadow, NY 11554
www.metrocbb.com



John R. Wilmarth
 (516) 640-5440 john@metrocb.com

Gerry Dantone
 (631) 623-6914 metrocb@aol.com

89-25A Queens Blvd, Elmhurst, Queens, NY 11373

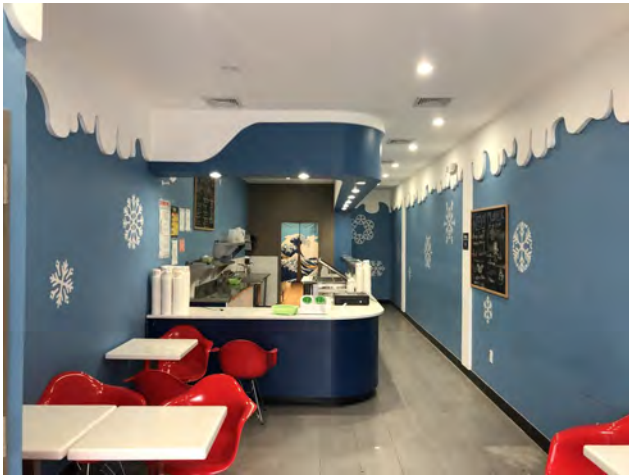

Metro Commercial &
Business Brokers, Inc.

For more information and inspection, contact
Metro Commercial & Business Brokers, Inc.
425 Linda Drive, East Meadow, NY 11554
www.metrocbb.com



Member of
International Council
of Shopping Centers

John R. Wilmarth
(516) 640-5440 john@metrocb.com

Gerry Dantone
(631) 623-6914 metrocb@aol.com

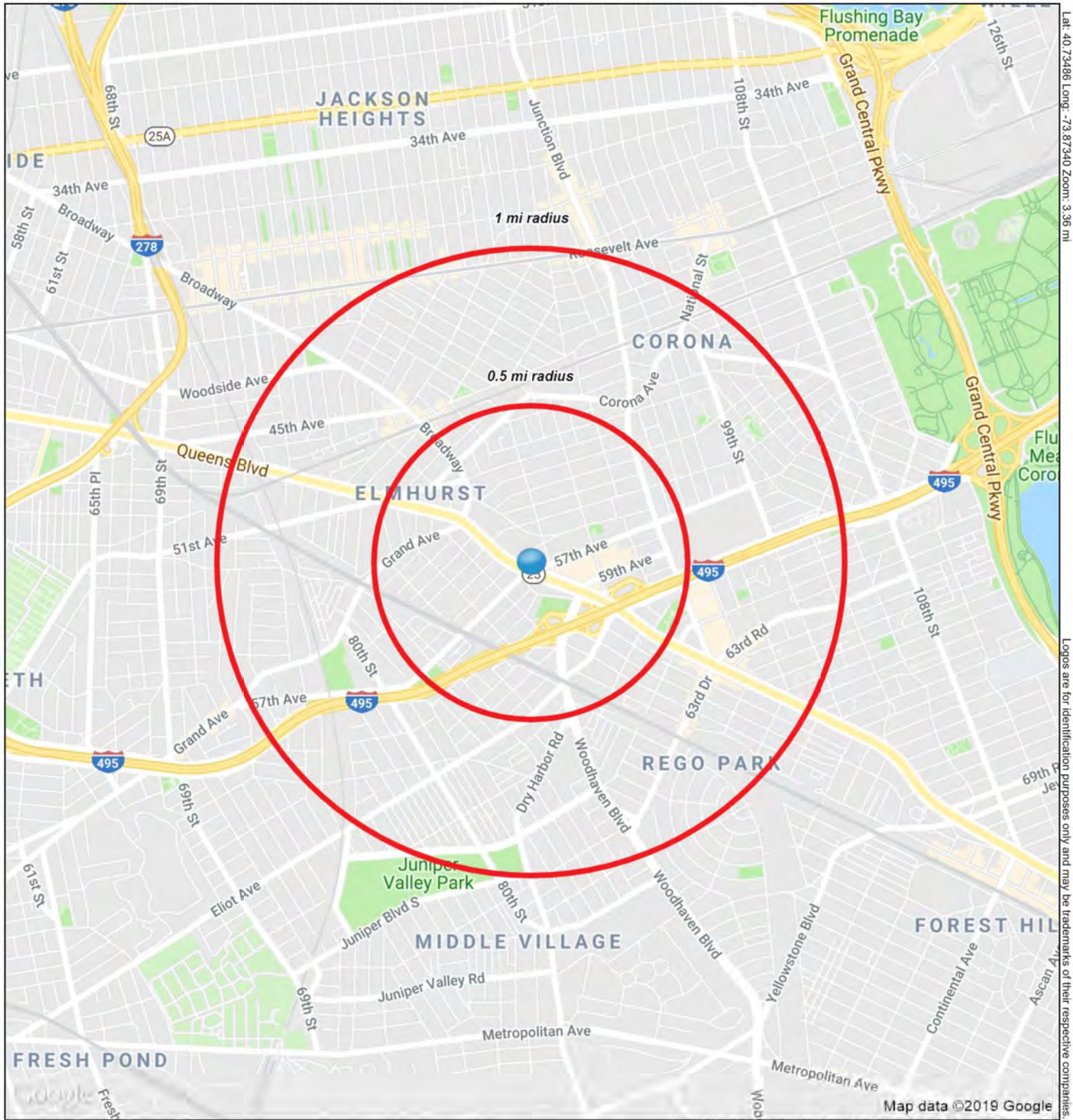

89-25 Queens Blvd
Elmhurst, NY 11373



May 2019

Metro Commercial & Business Brokers, Inc.

COMPLETE PROFILE

2000-2010 Census, 2019 Estimates with 2024 Projections

Calculated using Weighted Block Centroid from Block Groups



Metro Commercial & Business Brokers, Inc.

Lat/Lon: 40.7348/-73.8734

RFULL9

89-25 Queens Blvd Elmhurst, NY 11373	0.5 mi radius		1 mi radius		3 mi radius		5 mi radius	
Population								
Estimated Population (2019)	42,872		190,433		916,588		2.42 M	
Projected Population (2024)	42,373		188,367		909,301		2.39 M	
Census Population (2010)	40,849		181,356		869,882		2.25 M	
Census Population (2000)	40,332		178,583		865,952		2.21 M	
Projected Annual Growth (2019-2024)	-499	-0.2%	-2,066	-0.2%	-7,287	-0.2%	-27,646	-0.2%
Historical Annual Growth (2010-2019)	2,023	0.5%	9,077	0.5%	46,706	0.6%	175,214	0.8%
Historical Annual Growth (2000-2010)	517	0.1%	2,773	0.2%	3,930	-	41,459	0.2%
Estimated Population Density (2019)	54,964 psm		60,647 psm		32,434 psm		30,856 psm	
Trade Area Size	-		3.1 sq mi		28.3 sq mi		78.5 sq mi	
Households								
Estimated Households (2019)	14,631		64,559		326,853		890,261	
Projected Households (2024)	15,033		66,250		336,620		917,027	
Census Households (2010)	13,942		61,362		310,191		812,845	
Census Households (2000)	14,043		60,748		312,722		790,871	
Projected Annual Growth (2019-2024)	402	0.5%	1,691	0.5%	9,767	0.6%	26,766	0.6%
Historical Annual Change (2000-2019)	588	0.2%	3,811	0.3%	14,131	0.2%	99,390	0.7%
Average Household Income								
Estimated Average Household Income (2019)	\$74,021		\$73,984		\$82,298		\$89,834	
Projected Average Household Income (2024)	\$86,687		\$87,292		\$97,114		\$106,987	
Census Average Household Income (2010)	\$65,749		\$59,604		\$64,429		\$67,813	
Census Average Household Income (2000)	\$50,115		\$48,394		\$51,091		\$53,510	
Projected Annual Change (2019-2024)	\$12,666	3.4%	\$13,307	3.6%	\$14,816	3.6%	\$17,153	3.8%
Historical Annual Change (2000-2019)	\$23,906	2.5%	\$25,591	2.8%	\$31,207	3.2%	\$36,324	3.6%
Median Household Income								
Estimated Median Household Income (2019)	\$61,718		\$59,452		\$66,351		\$69,061	
Projected Median Household Income (2024)	\$71,713		\$68,749		\$76,807		\$79,872	
Census Median Household Income (2010)	\$52,512		\$48,309		\$52,870		\$52,965	
Census Median Household Income (2000)	\$39,953		\$38,727		\$41,523		\$40,855	
Projected Annual Change (2019-2024)	\$9,995	3.2%	\$9,296	3.1%	\$10,457	3.2%	\$10,811	3.1%
Historical Annual Change (2000-2019)	\$21,765	2.9%	\$20,725	2.8%	\$24,827	3.1%	\$28,207	3.6%
Per Capita Income								
Estimated Per Capita Income (2019)	\$25,274		\$25,098		\$29,386		\$33,155	
Projected Per Capita Income (2024)	\$30,767		\$30,718		\$35,991		\$41,109	
Census Per Capita Income (2010)	\$22,441		\$20,167		\$22,975		\$24,528	
Census Per Capita Income (2000)	\$17,140		\$16,352		\$18,358		\$19,096	
Projected Annual Change (2019-2024)	\$5,493	4.3%	\$5,620	4.5%	\$6,604	4.5%	\$7,955	4.8%
Historical Annual Change (2000-2019)	\$8,134	2.5%	\$8,746	2.8%	\$11,028	3.2%	\$14,059	3.9%
Estimated Average Household Net Worth (2019)	\$671,941		\$651,578		\$745,350		\$861,398	

This report was produced using data from private and government sources deemed to be reliable. The information herein is provided without representation or warranty.

COMPLETE PROFILE

2000-2010 Census, 2019 Estimates with 2024 Projections

Calculated using Weighted Block Centroid from Block Groups



Metro Commercial & Business Brokers, Inc.

Lat/Lon: 40.7348/-73.8734

RFULL9

89-25 Queens Blvd

Elmhurst, NY 11373

Race and Ethnicity

	0.5 mi radius		1 mi radius		3 mi radius		5 mi radius	
Total Population (2019)	42,872		190,433		916,588		2.42 M	
White (2019)	10,941	25.5%	65,556	34.4%	403,267	44.0%	980,106	40.5%
Black or African American (2019)	2,327	5.4%	14,612	7.7%	64,557	7.0%	428,643	17.7%
American Indian or Alaska Native (2019)	215	0.5%	1,090	0.6%	5,465	0.6%	14,911	0.6%
Asian (2019)	24,038	56.1%	74,044	38.9%	266,223	29.0%	584,484	24.1%
Hawaiian or Pacific Islander (2019)	20	-	80	-	369	-	1,442	-
Other Race (2019)	4,069	9.5%	27,978	14.7%	142,117	15.5%	318,999	13.2%
Two or More Races (2019)	1,263	2.9%	7,073	3.7%	34,590	3.8%	93,924	3.9%
Population < 18 (2019)	7,641	17.8%	37,071	19.5%	179,667	19.6%	489,130	20.2%
White Not Hispanic	759	9.9%	5,764	15.5%	41,111	22.9%	108,425	22.2%
Black or African American	423	5.5%	2,562	6.9%	11,153	6.2%	91,979	18.8%
Asian	3,958	51.8%	12,775	34.5%	46,184	25.7%	104,074	21.3%
Other Race Not Hispanic	180	2.4%	826	2.2%	4,336	2.4%	19,223	3.9%
Hispanic	2,321	30.4%	15,144	40.9%	76,882	42.8%	165,430	33.8%
Not Hispanic or Latino Population (2019)	31,967	74.6%	123,108	64.6%	579,877	63.3%	1.68 M	69.2%
Not Hispanic White	5,535	17.3%	34,608	28.1%	251,299	43.3%	649,661	38.8%
Not Hispanic Black or African American	1,940	6.1%	11,545	9.4%	47,546	8.2%	370,766	22.1%
Not Hispanic American Indian or Alaska Native	71	0.2%	271	0.2%	1,172	0.2%	5,293	0.3%
Not Hispanic Asian	23,457	73.4%	72,591	59.0%	260,753	45.0%	570,796	34.1%
Not Hispanic Hawaiian or Pacific Islander	15	-	48	-	185	-	884	-
Not Hispanic Other Race	283	0.9%	1,293	1.0%	6,067	1.0%	32,304	1.9%
Not Hispanic Two or More Races	665	2.1%	2,754	2.2%	12,855	2.2%	45,735	2.7%
Hispanic or Latino Population (2019)	10,905	25.4%	67,325	35.4%	336,711	36.7%	747,067	30.8%
Hispanic White	5,406	49.6%	30,948	46.0%	151,968	45.1%	330,445	44.2%
Hispanic Black or African American	387	3.5%	3,067	4.6%	17,011	5.1%	57,876	7.7%
Hispanic American Indian or Alaska Native	143	1.3%	820	1.2%	4,293	1.3%	9,618	1.3%
Hispanic Asian	581	5.3%	1,453	2.2%	5,470	1.6%	13,687	1.8%
Hispanic Hawaiian or Pacific Islander	5	-	33	-	184	-	558	-
Hispanic Other Race	3,786	34.7%	26,685	39.6%	136,050	40.4%	286,695	38.4%
Hispanic Two or More Races	598	5.5%	4,319	6.4%	21,735	6.5%	48,188	6.5%
Not Hispanic or Latino Population (2010)	29,217	71.5%	111,304	61.4%	529,934	60.9%	1.5 M	66.7%
Hispanic or Latino Population (2010)	11,632	28.5%	70,052	38.6%	339,948	39.1%	749,295	33.3%
Not Hispanic or Latino Population (2000)	28,726	71.2%	113,108	63.3%	559,353	64.6%	1.5 M	67.9%
Hispanic or Latino Population (2000)	11,605	28.8%	65,475	36.7%	306,599	35.4%	708,183	32.1%
Not Hispanic or Latino Population (2024)	32,339	76.3%	125,921	66.8%	592,126	65.1%	1.69 M	70.6%
Hispanic or Latino Population (2024)	10,034	23.7%	62,446	33.2%	317,175	34.9%	704,281	29.4%
Projected Annual Growth (2019-2024)	-872	-1.6%	-4,879	-1.4%	-19,536	-1.2%	-42,786	-1.1%
Historical Annual Growth (2000-2010)	27	-	4,577	0.7%	33,348	1.1%	41,112	0.6%

This report was produced using data from private and government sources deemed to be reliable. The information herein is provided without representation or warranty.

COMPLETE PROFILE

2000-2010 Census, 2019 Estimates with 2024 Projections

Calculated using Weighted Block Centroid from Block Groups



Metro Commercial & Business Brokers, Inc.

Lat/Lon: 40.7348/-73.8734

RFULL9

89-25 Queens Blvd

Elmhurst, NY 11373

Total Age Distribution (2019)

	0.5 mi radius		1 mi radius		3 mi radius		5 mi radius	
Total Population	42,872		190,433		916,588		2.42 M	
Age Under 5 Years	2,336	5.4%	11,584	6.1%	56,953	6.2%	152,362	6.3%
Age 5 to 9 Years	2,168	5.1%	10,690	5.6%	51,425	5.6%	138,888	5.7%
Age 10 to 14 Years	2,012	4.7%	9,582	5.0%	46,364	5.1%	128,065	5.3%
Age 15 to 19 Years	1,912	4.5%	8,994	4.7%	43,279	4.7%	122,270	5.0%
Age 20 to 24 Years	2,541	5.9%	11,268	5.9%	53,216	5.8%	151,117	6.2%
Age 25 to 29 Years	3,837	8.9%	16,079	8.4%	77,402	8.4%	221,749	9.2%
Age 30 to 34 Years	3,589	8.4%	15,610	8.2%	79,373	8.7%	216,642	8.9%
Age 35 to 39 Years	3,210	7.5%	14,671	7.7%	73,946	8.1%	190,777	7.9%
Age 40 to 44 Years	2,835	6.6%	12,731	6.7%	63,428	6.9%	162,332	6.7%
Age 45 to 49 Years	2,982	7.0%	12,817	6.7%	61,583	6.7%	157,048	6.5%
Age 50 to 54 Years	2,865	6.7%	12,418	6.5%	58,732	6.4%	149,365	6.2%
Age 55 to 59 Years	3,049	7.1%	12,804	6.7%	59,277	6.5%	149,333	6.2%
Age 60 to 64 Years	2,766	6.5%	11,881	6.2%	54,017	5.9%	135,426	5.6%
Age 65 to 69 Years	2,151	5.0%	9,326	4.9%	43,943	4.8%	112,498	4.6%
Age 70 to 74 Years	1,696	4.0%	7,455	3.9%	33,924	3.7%	85,665	3.5%
Age 75 to 79 Years	1,168	2.7%	5,074	2.7%	23,863	2.6%	60,265	2.5%
Age 80 to 84 Years	903	2.1%	3,593	1.9%	16,598	1.8%	41,432	1.7%
Age 85 Years or Over	851	2.0%	3,858	2.0%	19,266	2.1%	47,272	2.0%
Median Age	39.0		38.3		37.8		36.6	
Age 19 Years or Less	8,429	19.7%	40,849	21.5%	198,021	21.6%	541,585	22.4%
Age 20 to 64 Years	27,674	64.6%	120,279	63.2%	580,974	63.4%	1.53 M	63.3%
Age 65 Years or Over	6,769	15.8%	29,305	15.4%	137,594	15.0%	347,133	14.3%

Female Age Distribution (2019)

Female Population	22,167	51.7%	96,185	50.5%	461,601	50.4%	1.24 M	51.2%
Age Under 5 Years	1,125	5.1%	5,508	5.7%	27,370	5.9%	73,773	5.9%
Age 5 to 9 Years	1,048	4.7%	5,080	5.3%	24,627	5.3%	67,069	5.4%
Age 10 to 14 Years	993	4.5%	4,631	4.8%	22,299	4.8%	61,998	5.0%
Age 15 to 19 Years	947	4.3%	4,235	4.4%	20,331	4.4%	58,465	4.7%
Age 20 to 24 Years	1,245	5.6%	5,197	5.4%	25,108	5.4%	74,277	6.0%
Age 25 to 29 Years	1,942	8.8%	7,896	8.2%	38,094	8.3%	112,748	9.1%
Age 30 to 34 Years	1,846	8.3%	7,608	7.9%	38,435	8.3%	107,817	8.7%
Age 35 to 39 Years	1,536	6.9%	7,017	7.3%	35,133	7.6%	93,671	7.6%
Age 40 to 44 Years	1,443	6.5%	6,130	6.4%	30,184	6.5%	79,818	6.4%
Age 45 to 49 Years	1,528	6.9%	6,295	6.5%	30,068	6.5%	78,566	6.3%
Age 50 to 54 Years	1,518	6.8%	6,389	6.6%	29,871	6.5%	76,410	6.2%
Age 55 to 59 Years	1,627	7.3%	6,844	7.1%	30,899	6.7%	78,675	6.3%
Age 60 to 64 Years	1,462	6.6%	6,350	6.6%	29,044	6.3%	73,162	5.9%
Age 65 to 69 Years	1,176	5.3%	5,137	5.3%	24,088	5.2%	62,219	5.0%
Age 70 to 74 Years	956	4.3%	4,113	4.3%	18,922	4.1%	48,459	3.9%
Age 75 to 79 Years	676	3.0%	2,970	3.1%	13,835	3.0%	35,303	2.8%
Age 80 to 84 Years	550	2.5%	2,185	2.3%	10,328	2.2%	25,766	2.1%
Age 85 Years or Over	550	2.5%	2,599	2.7%	12,965	2.8%	31,892	2.6%
Female Median Age	40.6		40.2		39.4		38.0	
Age 19 Years or Less	4,113	18.6%	19,454	20.2%	94,627	20.5%	261,305	21.1%
Age 20 to 64 Years	14,147	63.8%	59,726	62.1%	286,836	62.1%	775,143	62.5%
Age 65 Years or Over	3,907	17.6%	17,005	17.7%	80,138	17.4%	203,638	16.4%

This report was produced using data from private and government sources deemed to be reliable. The information herein is provided without representation or warranty.

COMPLETE PROFILE

2000-2010 Census, 2019 Estimates with 2024 Projections

Calculated using Weighted Block Centroid from Block Groups



Metro Commercial & Business Brokers, Inc.

Lat/Lon: 40.7348/-73.8734

RFULL9

89-25 Queens Blvd

Elmhurst, NY 11373

Male Age Distribution (2019)

	0.5 mi radius		1 mi radius		3 mi radius		5 mi radius	
Male Population	20,705	48.3%	94,248	49.5%	454,987	49.6%	1.18 M	48.8%
Age Under 5 Years	1,211	5.8%	6,076	6.4%	29,583	6.5%	78,589	6.6%
Age 5 to 9 Years	1,120	5.4%	5,610	6.0%	26,798	5.9%	71,819	6.1%
Age 10 to 14 Years	1,019	4.9%	4,950	5.3%	24,064	5.3%	66,067	5.6%
Age 15 to 19 Years	965	4.7%	4,759	5.0%	22,948	5.0%	63,805	5.4%
Age 20 to 24 Years	1,296	6.3%	6,070	6.4%	28,108	6.2%	76,840	6.5%
Age 25 to 29 Years	1,895	9.2%	8,183	8.7%	39,308	8.6%	109,002	9.2%
Age 30 to 34 Years	1,744	8.4%	8,002	8.5%	40,938	9.0%	108,825	9.2%
Age 35 to 39 Years	1,675	8.1%	7,655	8.1%	38,813	8.5%	97,106	8.2%
Age 40 to 44 Years	1,392	6.7%	6,601	7.0%	33,244	7.3%	82,514	7.0%
Age 45 to 49 Years	1,454	7.0%	6,522	6.9%	31,515	6.9%	78,483	6.6%
Age 50 to 54 Years	1,347	6.5%	6,029	6.4%	28,860	6.3%	72,955	6.2%
Age 55 to 59 Years	1,422	6.9%	5,960	6.3%	28,378	6.2%	70,658	6.0%
Age 60 to 64 Years	1,304	6.3%	5,531	5.9%	24,972	5.5%	62,264	5.3%
Age 65 to 69 Years	975	4.7%	4,188	4.4%	19,856	4.4%	50,280	4.3%
Age 70 to 74 Years	739	3.6%	3,342	3.5%	15,002	3.3%	37,206	3.1%
Age 75 to 79 Years	493	2.4%	2,104	2.2%	10,028	2.2%	24,962	2.1%
Age 80 to 84 Years	354	1.7%	1,409	1.5%	6,270	1.4%	15,666	1.3%
Age 85 Years or Over	301	1.5%	1,258	1.3%	6,301	1.4%	15,380	1.3%
Male Median Age	37.6		36.6		36.3		35.2	
Age 19 Years or Less	4,316	20.8%	21,395	22.7%	103,394	22.7%	280,280	23.7%
Age 20 to 64 Years	13,527	65.3%	60,552	64.2%	294,137	64.6%	758,647	64.2%
Age 65 Years or Over	2,862	13.8%	12,300	13.1%	57,456	12.6%	143,495	12.1%

Males per 100 Females (2019)

Overall Comparison	93		98		99		95	
Age Under 5 Years	108	51.9%	110	52.5%	108	51.9%	107	51.6%
Age 5 to 9 Years	107	51.7%	110	52.5%	109	52.1%	107	51.7%
Age 10 to 14 Years	103	50.6%	107	51.7%	108	51.9%	107	51.9%
Age 15 to 19 Years	102	50.5%	112	52.9%	113	53.0%	109	52.2%
Age 20 to 24 Years	104	51.0%	117	53.9%	112	52.8%	103	50.8%
Age 25 to 29 Years	98	49.4%	104	50.9%	103	50.8%	97	49.2%
Age 30 to 34 Years	94	48.6%	105	51.3%	107	51.6%	101	50.2%
Age 35 to 39 Years	109	52.2%	109	52.2%	110	52.5%	104	50.9%
Age 40 to 44 Years	96	49.1%	108	51.8%	110	52.4%	103	50.8%
Age 45 to 49 Years	95	48.8%	104	50.9%	105	51.2%	100	50.0%
Age 50 to 54 Years	89	47.0%	94	48.5%	97	49.1%	95	48.8%
Age 55 to 59 Years	87	46.6%	87	46.5%	92	47.9%	90	47.3%
Age 60 to 64 Years	89	47.1%	87	46.6%	86	46.2%	85	46.0%
Age 65 to 69 Years	83	45.3%	82	44.9%	82	45.2%	81	44.7%
Age 70 to 74 Years	77	43.6%	81	44.8%	79	44.2%	77	43.4%
Age 75 to 79 Years	73	42.2%	71	41.5%	72	42.0%	71	41.4%
Age 80 to 84 Years	64	39.1%	64	39.2%	61	37.8%	61	37.8%
Age 85 Years or Over	55	35.4%	48	32.6%	49	32.7%	48	32.5%
Age 19 Years or Less	105	51.2%	110	52.4%	109	52.2%	107	51.8%
Age 20 to 39 Years	101	50.2%	108	51.9%	108	51.8%	101	50.2%
Age 40 to 64 Years	91	47.7%	96	48.9%	98	49.5%	95	48.7%
Age 65 Years or Over	73	42.3%	72	42.0%	72	41.8%	70	41.3%

This report was produced using data from private and government sources deemed to be reliable. The information herein is provided without representation or warranty.

COMPLETE PROFILE

2000-2010 Census, 2019 Estimates with 2024 Projections

Calculated using Weighted Block Centroid from Block Groups



Metro Commercial & Business Brokers, Inc.

Lat/Lon: 40.7348/-73.8734

RFULL9

89-25 Queens Blvd

Elmhurst, NY 11373

	0.5 mi radius		1 mi radius		3 mi radius		5 mi radius	
Household Type (2019)								
Total Households	14,631		64,559		326,853		890,261	
Households with Children	4,472	30.6%	20,906	32.4%	100,087	30.6%	267,386	30.0%
Average Household Size	2.9		2.9		2.8		2.7	
Household Density per Square Mile	18,758		20,560		11,566		11,339	
Population Family	36,586	85.3%	162,292	85.2%	758,269	82.7%	1.93 M	79.5%
Population Non-Family	6,237	14.5%	27,632	14.5%	153,150	16.7%	460,067	19.0%
Population Group Quarters	49	0.1%	508	0.3%	5,170	0.6%	36,868	1.5%
Family Households	10,265	70.2%	44,547	69.0%	214,122	65.5%	548,838	61.6%
Married Couple Households	7,129	69.5%	29,857	67.0%	145,732	68.1%	344,866	62.8%
Other Family Households with Children	3,135	30.5%	14,689	33.0%	68,390	31.9%	203,972	37.2%
Family Households with Children	4,435	43.2%	20,695	46.5%	99,210	46.3%	265,540	48.4%
Married Couple with Children	3,182	71.8%	14,201	68.6%	68,251	68.8%	161,400	60.8%
Other Family Households with Children	1,253	28.2%	6,494	31.4%	30,959	31.2%	104,140	39.2%
Family Households No Children	5,830	56.8%	23,852	53.5%	114,911	53.7%	283,298	51.6%
Married Couple No Children	3,947	67.7%	15,656	65.6%	77,480	67.4%	183,466	64.8%
Other Family Households No Children	1,883	32.3%	8,196	34.4%	37,431	32.6%	99,832	35.2%
Non-Family Households	4,366	29.8%	20,013	31.0%	112,731	34.5%	341,423	38.4%
Non-Family Households with Children	37	0.9%	211	1.1%	877	0.8%	1,846	0.5%
Non-Family Households No Children	4,329	99.1%	19,801	98.9%	111,854	99.2%	339,578	99.5%
Average Family Household Size	3.6		3.6		3.5		3.5	
Average Family Income	\$82,572		\$82,426		\$91,729		\$101,679	
Median Family Income	\$73,370		\$71,423		\$77,932		\$79,449	
Average Non-Family Household Size	1.4		1.4		1.4		1.3	
Marital Status (2019)								
Population Age 15 Years or Over	36,356		158,578		761,846		2 M	
Never Married	13,626	37.5%	58,921	37.2%	303,775	39.9%	877,407	43.8%
Currently Married	14,403	39.6%	60,302	38.0%	289,154	38.0%	714,420	35.7%
Previously Married	8,327	22.9%	39,355	24.8%	168,917	22.2%	411,366	20.5%
Separated	3,601	43.2%	16,902	42.9%	66,204	39.2%	162,118	39.4%
Widowed	2,443	29.3%	10,904	27.7%	46,710	27.7%	110,010	26.7%
Divorced	2,283	27.4%	11,548	29.3%	56,004	33.2%	139,238	33.8%
Educational Attainment (2019)								
Adult Population Age 25 Years or Over	31,902		138,316		665,351		1.73 M	
Elementary (Grade Level 0 to 8)	4,071	12.8%	19,852	14.4%	79,429	11.9%	181,787	10.5%
Some High School (Grade Level 9 to 11)	1,957	6.1%	10,365	7.5%	52,176	7.8%	151,079	8.7%
High School Graduate	8,632	27.1%	39,486	28.5%	195,003	29.3%	469,042	27.1%
Some College	4,214	13.2%	17,100	12.4%	81,319	12.2%	218,916	12.7%
Associate Degree Only	2,332	7.3%	9,153	6.6%	49,506	7.4%	121,041	7.0%
Bachelor Degree Only	7,342	23.0%	28,595	20.7%	130,657	19.6%	366,054	21.2%
Graduate Degree	3,355	10.5%	13,765	10.0%	77,262	11.6%	221,887	12.8%
Any College (Some College or Higher)	17,242	54.0%	68,613	49.6%	338,743	50.9%	927,898	53.6%
College Degree + (Bachelor Degree or Higher)	10,697	33.5%	42,360	30.6%	207,918	31.2%	587,941	34.0%

This report was produced using data from private and government sources deemed to be reliable. The information herein is provided without representation or warranty.

COMPLETE PROFILE

2000-2010 Census, 2019 Estimates with 2024 Projections

Calculated using Weighted Block Centroid from Block Groups



Metro Commercial & Business Brokers, Inc.

Lat/Lon: 40.7348/-73.8734

RFULL9

89-25 Queens Blvd

Elmhurst, NY 11373

	0.5 mi radius		1 mi radius		3 mi radius		5 mi radius	
Housing								
Total Housing Units (2019)	15,018		66,259		338,156		924,381	
Total Housing Units (2010)	14,657		64,647		331,691		879,172	
Historical Annual Growth (2010-2019)	361	0.3%	1,612	0.3%	6,466	0.2%	45,209	0.6%
Housing Units Occupied (2019)	14,631	97.4%	64,559	97.4%	326,853	96.7%	890,261	96.3%
Housing Units Owner-Occupied	5,024	34.3%	20,337	31.5%	113,444	34.7%	268,162	30.1%
Housing Units Renter-Occupied	9,607	65.7%	44,222	68.5%	213,409	65.3%	622,099	69.9%
Housing Units Vacant (2019)	387	2.6%	1,699	2.6%	11,304	3.5%	34,120	3.8%
Household Size (2019)								
Total Households	14,631		64,559		326,853		890,261	
1 Person Households	3,197	21.9%	15,361	23.8%	86,036	26.3%	259,160	29.1%
2 Person Households	3,848	26.3%	16,004	24.8%	87,199	26.7%	240,572	27.0%
3 Person Households	2,775	19.0%	11,529	17.9%	56,330	17.2%	147,195	16.5%
4 Person Households	2,363	16.1%	10,017	15.5%	46,680	14.3%	117,597	13.2%
5 Person Households	1,264	8.6%	5,651	8.8%	24,830	7.6%	63,538	7.1%
6 Person Households	582	4.0%	2,798	4.3%	12,244	3.7%	30,465	3.4%
7 or More Person Households	602	4.1%	3,199	5.0%	13,535	4.1%	31,732	3.6%
Household Income Distribution (2019)								
HH Income \$200,000 or More	650	4.4%	2,900	4.5%	17,948	5.5%	70,054	7.9%
HH Income \$150,000 to \$199,999	1,032	7.1%	4,223	6.5%	25,470	7.8%	69,925	7.9%
HH Income \$125,000 to \$149,999	982	6.7%	3,870	6.0%	22,256	6.8%	61,531	6.9%
HH Income \$100,000 to \$124,999	1,223	8.4%	5,227	8.1%	26,511	8.1%	68,434	7.7%
HH Income \$75,000 to \$99,999	1,996	13.6%	8,289	12.8%	47,168	14.4%	116,395	13.1%
HH Income \$50,000 to \$74,999	2,822	19.3%	11,608	18.0%	60,138	18.4%	147,336	16.5%
HH Income \$35,000 to \$49,999	1,739	11.9%	8,588	13.3%	39,381	12.0%	99,236	11.1%
HH Income \$25,000 to \$34,999	1,262	8.6%	5,691	8.8%	26,584	8.1%	67,755	7.6%
HH Income \$15,000 to \$24,999	1,238	8.5%	6,637	10.3%	28,672	8.8%	79,461	8.9%
HH Income \$10,000 to \$14,999	663	4.5%	2,581	4.0%	12,329	3.8%	37,402	4.2%
HH Income Under \$10,000	1,024	7.0%	4,945	7.7%	20,395	6.2%	72,732	8.2%
Household Vehicles (2019)								
Households 0 Vehicles Available	6,855	46.9%	31,871	49.4%	147,459	45.1%	449,982	50.5%
Households 1 Vehicle Available	5,934	40.6%	24,707	38.3%	132,721	40.6%	319,885	35.9%
Households 2 Vehicles Available	1,508	10.3%	6,341	9.8%	36,495	11.2%	93,261	10.5%
Households 3 or More Vehicles Available	334	2.3%	1,640	2.5%	10,178	3.1%	27,133	3.0%
Total Vehicles Available	10,079		42,867		239,635		596,924	
Average Vehicles per Household	-		-		-		-	
Owner-Occupied Household Vehicles	5,166	51.3%	20,604	48.1%	122,902	51.3%	303,259	50.8%
Average Vehicles per Owner-Occupied Household	1.0		1.0		1.1		1.1	
Renter-Occupied Household Vehicles	4,912	48.7%	22,263	51.9%	116,733	48.7%	293,665	49.2%
Average Vehicles per Renter-Occupied Household	-		-		-		-	
Travel Time (2019)								
Worker Base Age 16 years or Over	23,201		99,203		480,780		1.25 M	
Travel to Work in 14 Minutes or Less	1,250	5.4%	6,473	6.5%	32,128	6.7%	89,582	7.2%
Travel to Work in 15 to 29 Minutes	3,357	14.5%	14,585	14.7%	76,389	15.9%	203,472	16.3%
Travel to Work in 30 to 59 Minutes	11,206	48.3%	45,615	46.0%	226,666	47.1%	584,164	46.8%
Travel to Work in 60 Minutes or More	6,732	29.0%	28,519	28.7%	129,121	26.9%	320,707	25.7%
Work at Home	586	2.5%	2,443	2.5%	13,162	2.7%	42,799	3.4%
Average Minutes Travel to Work	45.8		44.3		42.9		41.9	

This report was produced using data from private and government sources deemed to be reliable. The information herein is provided without representation or warranty.

COMPLETE PROFILE

2000-2010 Census, 2019 Estimates with 2024 Projections

Calculated using Weighted Block Centroid from Block Groups



Metro Commercial & Business Brokers, Inc.

Lat/Lon: 40.7348/-73.8734

RFULL9

89-25 Queens Blvd

Elmhurst, NY 11373

	0.5 mi radius		1 mi radius		3 mi radius		5 mi radius	
Transportation To Work (2019)								
Worker Base Age 16 years or Over	23,201		99,203		480,780		1.25 M	
Drive to Work Alone	5,095	22.0%	23,260	23.4%	124,244	25.8%	307,184	24.6%
Drive to Work in Carpool	1,057	4.6%	5,442	5.5%	28,509	5.9%	65,371	5.2%
Travel to Work by Public Transportation	14,293	61.6%	58,429	58.9%	273,702	56.9%	710,895	57.0%
Drive to Work on Motorcycle	30	0.1%	130	0.1%	445	-	1,007	-
Bicycle to Work	89	0.4%	690	0.7%	2,983	0.6%	12,085	1.0%
Walk to Work	1,868	8.1%	8,302	8.4%	35,814	7.4%	101,855	8.2%
Other Means	182	0.8%	508	0.5%	1,921	0.4%	6,345	0.5%
Work at Home	586	2.5%	2,443	2.5%	13,162	2.7%	42,799	3.4%
Daytime Demographics (2019)								
Total Businesses	1,058		3,800		24,813		70,580	
Total Employees	18,095		37,499		201,681		602,782	
Company Headquarter Businesses	-	-	6	0.2%	50	0.2%	157	0.2%
Company Headquarter Employees	-	-	3,170	8.5%	13,136	6.5%	82,032	13.6%
Employee Population per Business	17.1 to 1		9.9 to 1		8.1 to 1		8.5 to 1	
Residential Population per Business	40.5 to 1		50.1 to 1		36.9 to 1		34.3 to 1	
Adj. Daytime Demographics Age 16 Years or Over	30,925		96,843		477,801		1.34 M	
Labor Force								
Labor Population Age 16 Years or Over (2019)	35,981		156,882		753,645		1.98 M	
Labor Force Total Males (2019)	17,159	47.7%	76,716	48.9%	370,217	49.1%	954,098	48.2%
Male Civilian Employed	12,220	71.2%	54,050	70.5%	266,023	71.9%	660,995	69.3%
Male Civilian Unemployed	406	2.4%	1,479	1.9%	6,931	1.9%	23,114	2.4%
Males in Armed Forces	10	-	10	-	99	-	408	-
Males Not in Labor Force	4,523	26.4%	21,176	27.6%	97,163	26.2%	269,581	28.3%
Labor Force Total Females (2019)	18,822	52.3%	80,166	51.1%	383,429	50.9%	1.03 M	51.8%
Female Civilian Employed	10,921	58.0%	43,465	54.2%	211,364	55.1%	579,904	56.5%
Female Civilian Unemployed	393	2.1%	1,370	1.7%	6,371	1.7%	20,797	2.0%
Females in Armed Forces	-	-	13	-	39	-	158	-
Females Not in Labor Force	7,509	39.9%	35,319	44.1%	165,654	43.2%	425,351	41.4%
Unemployment Rate	798	2.2%	2,849	1.8%	13,302	1.8%	43,912	2.2%
Occupation (2019)								
Occupation Population Age 16 Years or Over	23,141		97,515		477,387		1.24 M	
Occupation Total Males	12,220	52.8%	54,050	55.4%	266,023	55.7%	660,995	53.3%
Occupation Total Females	10,921	47.2%	43,465	44.6%	211,364	44.3%	579,904	46.7%
Management, Business, Financial Operations	2,894	12.5%	11,575	11.9%	61,665	12.9%	180,198	14.5%
Professional, Related	4,622	20.0%	17,511	18.0%	92,871	19.5%	282,432	22.8%
Service	6,426	27.8%	27,911	28.6%	123,592	25.9%	291,896	23.5%
Sales, Office	4,965	21.5%	20,523	21.0%	99,765	20.9%	266,076	21.4%
Farming, Fishing, Forestry	21	-	68	-	339	-	1,263	0.1%
Construction, Extraction, Maintenance	1,499	6.5%	8,243	8.5%	43,870	9.2%	95,551	7.7%
Production, Transport, Material Moving	2,714	11.7%	11,683	12.0%	55,286	11.6%	123,483	10.0%
White Collar Workers	12,481	53.9%	49,610	50.9%	254,300	53.3%	728,706	58.7%
Blue Collar Workers	10,660	46.1%	47,905	49.1%	223,087	46.7%	512,193	41.3%

This report was produced using data from private and government sources deemed to be reliable. The information herein is provided without representation or warranty.

COMPLETE PROFILE

2000-2010 Census, 2019 Estimates with 2024 Projections

Calculated using Weighted Block Centroid from Block Groups



Metro Commercial & Business Brokers, Inc.

Lat/Lon: 40.7348/-73.8734

RFULL9

89-25 Queens Blvd

Elmhurst, NY 11373

0.5 mi radius 1 mi radius 3 mi radius 5 mi radius

Units In Structure (2019)

	0.5 mi radius		1 mi radius		3 mi radius		5 mi radius	
Total Units	13,942		61,362		310,191		812,845	
1 Detached Unit	1,915	13.7%	7,603	12.4%	40,337	13.0%	90,688	11.2%
1 Attached Unit	965	6.9%	4,624	7.5%	26,120	8.4%	59,646	7.3%
2 Units	2,269	16.3%	9,443	15.4%	59,748	19.3%	150,639	18.5%
3 to 4 Units	2,412	17.3%	8,553	13.9%	40,114	12.9%	107,528	13.2%
5 to 9 Units	747	5.4%	2,888	4.7%	22,755	7.3%	75,978	9.3%
10 to 19 Units	451	3.2%	2,268	3.7%	14,190	4.6%	50,832	6.3%
20 to 49 Units	1,192	8.6%	6,994	11.4%	38,639	12.5%	118,686	14.6%
50 or More Units	4,670	33.5%	22,154	36.1%	84,676	27.3%	235,362	29.0%
Mobile Home or Trailer	5	-	26	-	245	-	766	-
Other Structure	4	-	6	-	28	-	137	-

Homes Built By Year (2019)

Homes Built 2014 or later	67	0.4%	271	0.4%	1,239	0.4%	8,245	0.9%
Homes Built 2010 to 2013	172	1.1%	724	1.1%	3,286	1.0%	19,033	2.1%
Homes Built 2000 to 2009	582	3.9%	1,853	2.8%	9,921	2.9%	48,204	5.2%
Homes Built 1990 to 1999	549	3.7%	1,927	2.9%	8,198	2.4%	29,273	3.2%
Homes Built 1980 to 1989	848	5.6%	2,794	4.2%	10,830	3.2%	35,556	3.8%
Homes Built 1970 to 1979	1,060	7.1%	4,221	6.4%	18,580	5.5%	57,091	6.2%
Homes Built 1960 to 1969	3,423	22.8%	12,635	19.1%	45,905	13.6%	108,798	11.8%
Homes Built 1950 to 1959	2,784	18.5%	13,411	20.2%	62,412	18.5%	139,494	15.1%
Homes Built 1940 to 1949	1,992	13.3%	10,733	16.2%	52,391	15.5%	110,296	11.9%
Homes Built Before 1939	3,154	21.0%	15,990	24.1%	114,092	33.7%	334,271	36.2%
Median Age of Homes	56.4 yrs		59.2 yrs		62.3 yrs		60.5 yrs	

Home Values (2019)

Owner Specified Housing Units	4,816		19,515		108,488		255,180	
Home Values \$1,000,000 or More	345	7.2%	1,401	7.2%	7,864	7.2%	23,598	9.2%
Home Values \$750,000 to \$999,999	913	19.0%	3,479	17.8%	19,649	18.1%	46,805	18.3%
Home Values \$500,000 to \$749,999	1,483	30.8%	5,936	30.4%	33,725	31.1%	76,868	30.1%
Home Values \$400,000 to \$499,999	657	13.6%	2,742	14.0%	15,692	14.5%	34,787	13.6%
Home Values \$300,000 to \$399,999	552	11.5%	2,258	11.6%	12,600	11.6%	27,027	10.6%
Home Values \$250,000 to \$299,999	273	5.7%	1,116	5.7%	5,909	5.4%	11,258	4.4%
Home Values \$200,000 to \$249,999	279	5.8%	1,099	5.6%	5,783	5.3%	11,099	4.3%
Home Values \$175,000 to \$199,999	84	1.7%	414	2.1%	2,202	2.0%	4,110	1.6%
Home Values \$150,000 to \$174,999	90	1.9%	448	2.3%	2,163	2.0%	4,431	1.7%
Home Values \$125,000 to \$149,999	43	0.9%	203	1.0%	897	0.8%	1,725	0.7%
Home Values \$100,000 to \$124,999	63	1.3%	321	1.6%	1,524	1.4%	3,445	1.4%
Home Values \$90,000 to \$99,999	13	0.3%	67	0.3%	369	0.3%	737	0.3%
Home Values \$80,000 to \$89,999	2	-	18	-	77	-	330	0.1%
Home Values \$70,000 to \$79,999	7	0.1%	20	0.1%	173	0.2%	392	0.2%
Home Values \$60,000 to \$69,999	12	0.2%	57	0.3%	327	0.3%	670	0.3%
Home Values \$50,000 to \$59,999	11	0.2%	35	0.2%	209	0.2%	698	0.3%
Home Values \$35,000 to \$49,999	19	0.4%	49	0.3%	226	0.2%	617	0.2%
Home Values \$25,000 to \$34,999	2	-	12	-	109	0.1%	375	0.1%
Home Values \$10,000 to \$24,999	13	0.3%	46	0.2%	317	0.3%	875	0.3%
Home Values Under \$10,000	35	0.7%	138	0.7%	844	0.8%	2,115	0.8%
Owner-Occupied Median Home Value	\$547,825		\$540,727		\$550,116		\$613,357	
Renter-Occupied Median Rent	\$1,470		\$1,383		\$1,400		\$1,431	

This report was produced using data from private and government sources deemed to be reliable. The information herein is provided without representation or warranty.

COMPLETE PROFILE

2000-2010 Census, 2019 Estimates with 2024 Projections

Calculated using Weighted Block Centroid from Block Groups



Metro Commercial & Business Brokers, Inc.

Lat/Lon: 40.7348/-73.8734

RFULL9

89-25 Queens Blvd

Elmhurst, NY 11373

Total Annual Consumer Expenditure (2019)

	0.5 mi radius	1 mi radius	3 mi radius	5 mi radius
Total Household Expenditure	\$838.18 M	\$3.68 B	\$20.07 B	\$57.89 B
Total Non-Retail Expenditure	\$444.82 M	\$1.96 B	\$10.66 B	\$30.88 B
Total Retail Expenditure	\$393.36 M	\$1.72 B	\$9.41 B	\$27.01 B
Apparel	\$29.98 M	\$131.66 M	\$718.51 M	\$2.08 B
Contributions	\$25.89 M	\$113.87 M	\$631.68 M	\$1.86 B
Education	\$25.25 M	\$111.13 M	\$613.95 M	\$1.86 B
Entertainment	\$46.63 M	\$204.36 M	\$1.12 B	\$3.25 B
Food and Beverages	\$125.31 M	\$550.01 M	\$2.99 B	\$8.57 B
Furnishings and Equipment	\$29.09 M	\$127.36 M	\$699.77 M	\$2.03 B
Gifts	\$19.93 M	\$87.5 M	\$485.77 M	\$1.45 B
Health Care	\$70.73 M	\$310.27 M	\$1.69 B	\$4.8 B
Household Operations	\$32.43 M	\$142.34 M	\$780.42 M	\$2.26 B
Miscellaneous Expenses	\$15.84 M	\$69.59 M	\$380.34 M	\$1.1 B
Personal Care	\$11.31 M	\$49.6 M	\$270.81 M	\$780.14 M
Personal Insurance	\$5.65 M	\$24.72 M	\$137.1 M	\$400.94 M
Reading	\$1.8 M	\$7.9 M	\$43.34 M	\$125.48 M
Shelter	\$179.65 M	\$790.95 M	\$4.3 B	\$12.47 B
Tobacco	\$5.38 M	\$23.74 M	\$125.62 M	\$351.51 M
Transportation	\$150.28 M	\$657.29 M	\$3.59 B	\$10.26 B
Utilities	\$63.03 M	\$276.92 M	\$1.49 B	\$4.23 B

Monthly Household Consumer Expenditure (2019)

	0.5 mi radius	1 mi radius	3 mi radius	5 mi radius
Total Household Expenditure	\$4,774	\$4,749	\$5,117	\$5,419
Total Non-Retail Expenditure	\$2,534 53.1%	\$2,524 53.1%	\$2,718 53.1%	\$2,891 53.3%
Total Retail Expenditures	\$2,240 46.9%	\$2,226 46.9%	\$2,399 46.9%	\$2,528 46.7%
Apparel	\$171 3.6%	\$170 3.6%	\$183 3.6%	\$195 3.6%
Contributions	\$147 3.1%	\$147 3.1%	\$161 3.1%	\$175 3.2%
Education	\$144 3.0%	\$143 3.0%	\$157 3.1%	\$174 3.2%
Entertainment	\$266 5.6%	\$264 5.6%	\$286 5.6%	\$305 5.6%
Food and Beverages	\$714 15.0%	\$710 14.9%	\$761 14.9%	\$802 14.8%
Furnishings and Equipment	\$166 3.5%	\$164 3.5%	\$178 3.5%	\$190 3.5%
Gifts	\$114 2.4%	\$113 2.4%	\$124 2.4%	\$136 2.5%
Health Care	\$403 8.4%	\$400 8.4%	\$430 8.4%	\$449 8.3%
Household Operations	\$185 3.9%	\$184 3.9%	\$199 3.9%	\$212 3.9%
Miscellaneous Expenses	\$90 1.9%	\$90 1.9%	\$97 1.9%	\$103 1.9%
Personal Care	\$64 1.3%	\$64 1.3%	\$69 1.3%	\$73 1.3%
Personal Insurance	\$32 0.7%	\$32 0.7%	\$35 0.7%	\$38 0.7%
Reading	\$10 0.2%	\$10 0.2%	\$11 0.2%	\$12 0.2%
Shelter	\$1,023 21.4%	\$1,021 21.5%	\$1,096 21.4%	\$1,167 21.5%
Tobacco	\$31 0.6%	\$31 0.6%	\$32 0.6%	\$33 0.6%
Transportation	\$856 17.9%	\$848 17.9%	\$916 17.9%	\$961 17.7%
Utilities	\$359 7.5%	\$357 7.5%	\$381 7.4%	\$396 7.3%

This report was produced using data from private and government sources deemed to be reliable. The information herein is provided without representation or warranty.