



THE ADVENTURE STARTS WITH A RV

**RENT ONE OF OUR RVs
8 DAYS / 7 NIGHTS**



The best way to discover the beauty of Canada is by RV. These kind of vehicles are ideal for people looking for autonomy, flexibility and adventure of course. Departing from Vancouver, Calgary, Edmonton, Whitehorse, Toronto or Montreal you will realize your dream vacation!

C-Small Motorhome

Sleeping Capacity: 3 persons
Recommended for 2 adults and 1 child
Seat Belts Available: 4

Day



Night



SPECIAL FEATURE

- Solar Panel
- Awning
- Large panorama windows in dinette



OTHER FEATURES

- Automatic Transmission: 4 Speed Overdrive
- Ford Chassis: V8 Gas Engine
- Child seat option: No
- Backup Camera
- Overcab Bed: 135cm x 213cm / 53" x 84"
- Dinette Bed: 122cm x 183cm / 48" x 72"
- Overall Length: 617cm / 20'3"
- Overall Width: 229cm / 7'6"
- Overall Height: 340cm / 11'2"
- Interior Height: 200cm / 6'6"
- Fresh Water: 107 - 115 L
- Black Water: 75 L
- Grey Water: 75 L
- Gas Capacity: 151 L
- Propane Capacity: 32 L
- Cruise Control
- Tilt Steering Wheel
- Dash Air Conditioning
- Roof Air Conditioning
- Dual Battery
- Fridge
- Propane Stove/ Oven
- Microwave
- Hot Water Heater
- Shower
- Flush Toilet
- Furnace

All measurements are approximate and floorplans are subject to change.

INCLUSIONS

- 8 days /7 night RV rental
- Preparation fee (mandatory charge per vehicle per rental). It includes initial propane fill, toilet chemicals, 2 rolls of biodegradable toilet paper, fresh water & sewer hoses, rubber gloves, basic tool set, spare 15 Amp fuses
- Federal and provincial taxes
- One-way rental drop fee if applicable (packages YVR-YYC and YYC-YVR)

Not Included: Flights · Airport transfers and other transfers · Fuel for RV, taxes and insurance · Toll charges · Mileages · Meals · Gratuities · Beverages · Optional excursions · Entry fees to the parks · Attractions unless otherwise specified

DEPARTURE FOR 2021

Price in \$CAD, per vehicle starting from	Pick up – drop off cities						
7 nights / 8 days	YVR-YVR	YYC-YYC / YEG-YEG	YXI-YXI	YYZ-YYZ	YVR-YYC	YYC-YVR	YUL-YUL*
Jan 1 – May 31	765	715	769	649	1399	1709	On request
Jun 1 – Jun 30	1129	1059	1415	979	1769	2049	On request
Jul 1 – Aug 31	1709	1599	1499	1575	2349	2589	On request
Sep 01 – Sep 25	1359	1269	1415	1365	1995	2259	On request
Sep 26 – Dec 31	715	669	709	869	1349	1659	On request

* Note: for all combinations including the city of Montreal (pick-up or drop-off): please contact us for prices and details

C-Medium Motorhome

Sleeping Capacity: 5 persons
Recommended for 4 adults and 1 child
Seat Belts Available: 6

Day



Night



SPECIAL FEATURE

- Solar Panel
- Awning
- Large panorama windows in dinette
- Generator



OTHER FEATURES

- Ford Chassis: V8/ V10 Gas Engine
- Automatic Transmission: 4 Speed Overdrive
- Overcab Bed: 135cm x 203cm / 53" x 80"
- Rear Bed: 145cm x 200cm / 57" x 79"
- Dinette Bed: 113cm x 167cm / 44" x 66"
- Overall Length: 721cm / 23'8"
- Overall Width: 250cm / 8'2"
- Overall Height: 340cm / 11'2"
- Interior Height: 200cm / 6'6"
- Fresh Water: 115 L
- Black Water: 85 L
- Grey Water: 98 L
- Gas Capacity: 140 L
- Propane Capacity: 87 L
- Cruise Control
- Tilt Steering Wheel
- Child seat option
- Dash Air Conditioning
- Flush Toilet
- Roof Air Conditioning
- Backup Camera
- Dual Battery
- Fridge
- Convection Oven/ Microwave
- Stove
- Shower
- Hot Water Heater
- Furnace

All measurements are approximate and floorplans are subject to change.

INCLUSIONS

- 8 days /7 night RV rental
- Preparation fee (mandatory charge per vehicle per rental). It includes initial propane fill, toilet chemicals, 2 rolls of biodegradable toilet paper, fresh water & sewer hoses, rubber gloves, basic tool set, spare 15 Amp fuses
- Federal and provincial taxes
- One-way rental drop fee if applicable (packages YVR-YYC and YYC-YVR)

Not Included: Flights · Airport transfers and other transfers · Fuel for RV, taxes and insurance · Toll charges · Mileages · Meals · Gratuities · Beverages · Optional excursions · Entry fees to the parks · Attractions unless otherwise specified

DEPARTURE FOR 2021

Price in \$CAD, per vehicle starting from	Pick up – drop off cities						
7 nights / 8 days	YVR-YVR	YYC-YYC / YEG-YEG	YXI-YXI	YYZ-YYZ	YVR-YYC	YYC-YVR	YUL-YUL*
Jan 1 – May 31	829	769	885	725	1465	1765	On request
Jun 1 – Jun 30	1269	1189	1599	1099	1905	2179	On request
Jul 1 – Aug 31	2015	1885	1919	1879	2649	2879	On request
Sep 01 – Sep 25	1509	1415	1599	1429	2145	2405	On request
Sep 26 – Dec 31	765	715	769	979	1399	1709	On request

* Note: for all combinations including the city of Montreal (pick-up or drop-off): please contact us for prices and details

Van Conversion

Sleeping Capacity: 2 persons

Recommended for 2 adults

Seat Belts Available: 4

Day

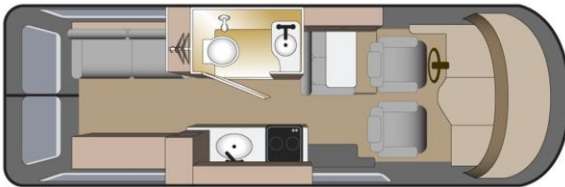

Night

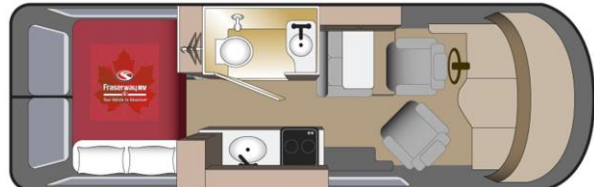

SPECIAL FEATURE

- **Solar Panel**
- **Awning**
- **Generator**
- **Fuel Efficient Ford Transit V6 Engine**



OTHER FEATURES

- Automatic Transmission: 4 Speed Overdrive
- Ford Transit Chassis: V6 Gas Engine
- Child seat option: No
- Backup Camera
- Rear Bed: 120cm x 183cm / 47" x 72"
- Overall Length: 670cm / 22"
- Overall Width: 210cm / 6'11"
- Overall Height: 340cm / 11'2"
- Interior Height: 195cm / 6'4"
- Exterior Height: 301cm / 118'5"
- Fresh Water: 79 L
- Black Water: 45 L
- Grey Water: 53 L
- Gas Capacity: 95 L
- Propane Capacity: 22 L
- Cruise Control
- Dash Air Conditioning
- Roof Air Conditioning
- Dual Battery
- Fridge
- Propane Stove/ Oven
- Microwave
- Hot Water Heater
- Shower
- Flush Toilet
- Furnace

All measurements are approximate and floor plans are subject to change.

INCLUSIONS

- 8 days /7 night RV rental
- Preparation fee (mandatory charge per vehicle per rental). It includes initial propane fill, toilet chemicals, 2 rolls of biodegradable toilet paper, fresh water & sewer hoses, rubber gloves, basic tool set, spare 15 Amp fuses
- Federal and provincial taxes
- One-way rental drop fee if applicable (packages YVR-YYC and YYC-YVR)

Not Included: Flights · Airport transfers and other transfers · Fuel for RV, taxes and insurance · Toll charges · Mileages · Meals · Gratuities · Beverages · Optional excursions · Entry fees to the parks · Attractions unless otherwise specified

DEPARTURE FOR 2021

Price in \$CAD, per vehicle starting from	Pick up – drop off cities						
7 nights / 8 days	YVR-YVR	YYC-YYC / YEG-YEG	YXI-YXI	YYZ-YYZ	YVR-YYC	YYC-YVR	YUL-YUL*
Jan 1 – May 31	795	749	N/A	685	1429	1739	On request
Jun 1 – Jun 30	1129	1059	N/A	969	1769	2049	On request
Jul 1 – Aug 31	1659	1549	N/A	1565	2299	2539	On request
Sep 01 – Sep 25	1359	1269	N/A	1269	1995	2259	On request
Sep 26 – Dec 31	755	709	N/A	869	1389	1699	On request
* Note: for all combinations including the city of Montreal (pick-up or drop-off): please contact us for prices and details							

TC-S (Truck-Camper with Slide-out)

Sleeping Capacity: 3 persons
Recommended for 2 adults and 1 child
Seat Belts Available: 5

Day

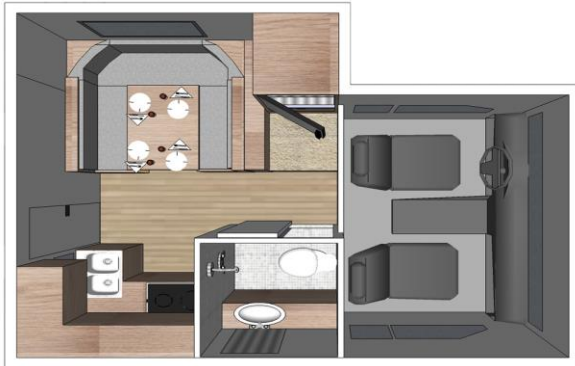

Night



SPECIAL FEATURE

- Solar Panel
- Awning
- Slide-out
- Fuel Efficient Diesel Engine
- 4 x 4



OTHER FEATURES

- Automatic Transmission: 4 Speed Overdrive
- Ford / Dodge Chassis: V8 Diesel Engine
- Child seat option: Yes
- Backup Camera: No
- Cruise Control
- Tilt Steering Wheel
- Overall Length: 724-757 cm / 23'9"-24'10"
- Overall Width: 250cm / 8'2"
- Overall Height: 389cm / 13'1"
- Overall Width with Slide-out extended: 301cm / 118'5"
- Interior Height: 197cm / 6'5"
- Fresh Water: 142 L
- Black Water: 68-106 L
- Grey Water: 115-136 L
- Diesel Capacity: 98-128 L
- Propane Capacity: 32 L
- Dash Air Conditioning
- Dual Battery
- Fridge
- Propane Oven
- Stove
- Hot Water Heater
- Shower
- Flush Toilet
- Furnace
- Dinette Bed: 106cm x 167cm / 41" x 66"
- Overcab Bed: 150cm x 196cm / 59" x 77"

All measurements are approximate and floor plans are subject to change.

INCLUSIONS

- 8 days / 7 night RV rental
- Preparation fee (mandatory charge per vehicle per rental). It includes initial propane fill, toilet chemicals, 2 rolls of biodegradable toilet paper, fresh water & sewer hoses, rubber gloves, basic tool set, spare 15 Amp fuses
- Federal and provincial taxes
- One-way rental drop fee if applicable (packages YVR-YYC and YYC-YVR)

Not Included: Flights · Airport transfers and other transfers · Fuel for RV, taxes and insurance · Toll charges · Mileages · Meals · Gratuities · Beverages · Optional excursions · Entry fees to the parks · Attractions unless otherwise specified

DEPARTURE FOR 2021

Price in \$CAD, per vehicle starting from	Pick up – drop off cities						
7 nights / 8 days	YVR-YVR	YYC-YYC / YEG-YEG	YXI-YXI	YYZ-YYZ	YVR-YYC	YYC-YVR	YUL-YUL*
Jan 1 – May 31	869	809	845	765	1505	1795	On request
Jun 1 – Jun 30	1295	1205	1499	1115	1929	2199	On request
Jul 1 – Aug 31	1759	1645	1645	1669	2395	2639	On request
Sep 01 – Sep 25	1459	1365	1599	1365	2099	2359	On request
Sep 26 – Dec 31	869	809	769	979	1505	1805	On request

*** Note: for all combinations including the city of Montreal (pick-up or drop-off): please contact us for prices and details**



SUPPLEMENTS			
Price in \$CAD	Pick up in Vancouver	Pick up in Calgary, Edmonton or Whitehorse	Pick up in Toronto
Convenience kit*	\$125 per person	\$115 per person	\$125 per person
100 Km Pack	\$42 per rental	\$40 per rental	\$43 per rental
500 Km Pack	\$207 per rental	\$193 per rental	\$208 per rental
1000 Km Pack	\$403 per rental	\$377 per rental	\$406 per rental
Unlimited Kms	\$96 per day	\$90 per day	\$97 per day
Additional Kms**	\$ 0.52 per km	\$ 0.49 per km	\$ 0.52 per km
*Child (0-12) free when all adults are paying.			
**If applicable, to be paid on spot at the end of the trip.			
Note: for all combinations including the city of Montreal (pick-up or drop-off): please contact us for prices and details			

CONVENIENCE KITS – Inclusions

Pots, pans and kettle
Dinner set
Cutlery set
Steak knives
Coffee cups / glasses
One extra dinner set (guest)
Mixing bowls
Assorted kitchen utensils
Cutting board Bed sheet
Strainer Fleece blanket
Food savers
Hot Beverage kit
Oven dish
Can opener
Cork screw
Salt + Pepper shakers

Ice cube tray
Toaster
Garbage can
Bucket
Pail/broom and dust pan
Clothes hangers
Clothes line / clothes pins
Gas Lighter
Comforter in duvet cover
Pillow and pillow case
Dish towels / sponge / soap
Towels / body soap
Flashlight
Fly swatter
Axe
Lawn chair

Important information

Cleaning of Vehicles

- All vehicles must be clean inside when returned. This includes kitchen, bathroom and living areas. A charge of \$50 per hour for cleaning will be applied for those vehicles returned in an unsatisfactory state. Vehicle holding tanks requiring dumping by the supplier's staff will result in a \$35 service charge. Outside washing is not required, unless the check-in procedure cannot be performed due to dirt on the vehicle.
- Smoking is not allowed in any of the vehicles. The supplier reserves the right to charge an additional cleaning fee of \$250.00 if a vehicle returns smelling of smoke.
- A valid driver's license is mandatory. Drivers must be 25 years or older, no maximum age limit.

**Pick Up**

- Vehicles can be collected at the rental stations from Monday to Saturday between 08:30 AM and 3:00 PM local time (on Sundays at selected stations).

Drop Off

- 08:30 AM to 11:30 AM, inspection ready. Sufficient time should be allowed for packing suitcases and cleaning vehicles. Late returns are not allowed without permission. If the vehicle is returned late without permission, overtime hours are charged up to maximum of 4 times the daily retail rate.
- If the renter returns the vehicle to any location other than the location indicated on the rental contract, the renter agrees to pay regular rates plus applicable redistribution charge or towing charge.
- Early Return: the supplier will not offer any refunds for rentals returned prior to the arranged drop off date.

Fuel

- The vehicle has to be returned with a full tank of fuel. If the renter does not refuel, the renter agrees to pay for having the vehicle refueled at a rate of \$3.00 per litre.

Pets (Dogs only)

- On request only. A charge of \$100.00 per dog will apply.

Seatbelts

- The number of passengers may not exceed the number of seatbelts while the vehicle is in motion.

Security Deposit

- A pre-authorization of a major credit card (Visa, MasterCard or American Express) is required while the vehicle is rented. This also applies to rentals which include CDW. Cash rentals are not allowed.
- In cases where the CDR is not purchased, the supplier will block the full amount of the deductible (\$7500) on the customer's credit card.

****Prices in this document are for information only; they were issued at press time, for the current year. Please note that due to exchange rates and temporary promotions, they can increase or decrease at any time. Contact your travel agent for the price and promotion of the moment.**